

IS 3180

Great performers for industry and business.
100% surveillance over up to 500 m².

Business yards are often used for storing tools and work materials worth hundreds of thousands. So it's important to have far-sighted guards that instantly respond to any movement. This is where the IS 3180 makes just the right choice. IP 54 rating reliably protects its inner values: featuring top-class components, like two modular pyro sensors and multi-lens, it watches over almost every last inch of areas measuring a good 500 m². You could hardly wish for any better "watchdog".



EAN IS 3180, white	4007841 606213
EAN IS 3180, stainless steel	4007841 606312
EAN IS 3180, black	4007841 606114
Type	Motion detector
Dimensions (H x W x D)	95 x 95 x 65 mm
Power supply	230 - 240 V, 50 Hz (2.5 mm ² max)
Sensor type	Passive infrared
Where to use	Indoors and outdoors
Installation	Wall, corner
Recommended installation height	2.00 m
Output (resistive load, e.g. ordinary lamp)	2000 W max.
Output (uncorrected, inductive, cos φ = 0.5, e.g. fluorescent lamps)	1000 VA max.
Output (series-corrected)	900 W max.
Output (parallel-corrected, with C ≤ 45.6 μF)	500 W max.
Output (electronic ballasts, capacitive, e.g. low-energy lamps)	.8 each max., C ≤ 176 μF
Angle of coverage	180° with 90° angle of aperture
Capability of masking out individual segments	Yes
Reach	Basic setting 1: 8 - 20 m tangentially; temperature. + precision adjustment by re-positioning the lens and using shrouds
Sensor system	7 detection levels, 448 switching zones
Response light level	.2 - 2000 lx
Response light level teach function	Yes
Time setting	5 sec. - 15 min., pulse mode (approx. 2 sec.)
Manual override	Selectable, 4 h
IP rating	IP54
Protection class	II
Temperature range	-20 - +50 °C

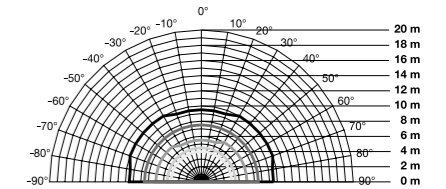
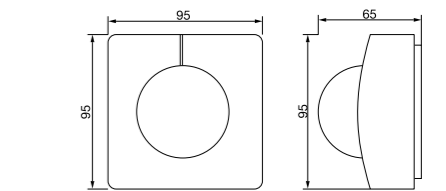

IS 3180 detection zone
 Mounting height 2 m,
 tangential walking direction, 8 m lens

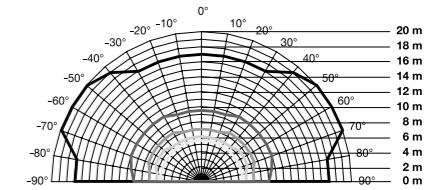

IS 3180 detection zone
 Installation height 2 m,
 tangential walking direction, 20 m lens

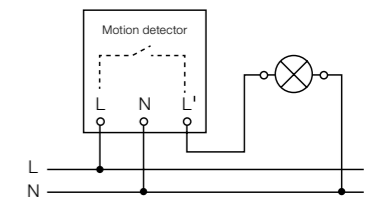

Also suitable for parallel operating mode.
 Intrinsic light detection.

Further circuit diagrams starting on page 328

Accessories

EAN corner wall mount bracket 04, white	4007841 648114
EAN corner wall mount bracket 04, black	4007841 648015

Refer to 'Accessories' for further information.



white



stainless steel



black



UV-resistant plastic



Large terminal compartment



Optional corner wall mount 04 available

